

# AMP-i50B v2

Wall-Mount Wireless Multi-Room Stereo Amplifier



Wi-Fi&bluetooth  
Two connections



Ethernet port



Class D  
80W/40x2



Analog&coaxial  
Two input



EQ  
Settings



Gapless  
playback



IR control



Smart home  
RS232/open API

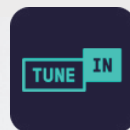
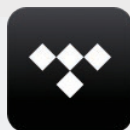
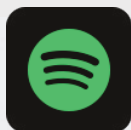

# Specifications

Type	Wireless Multi-Room Stereo Amplifier	
Inputs	WiFi, Bluetooth V5.0,AUX in,Coaxial in,USB 2.0	
Outputs	Number of output channels	2
	Power (W / channel)   4 ohms   1 kHz	> 50 W @ 1% THD+N
	Power (W / channel)   8 ohms   1 kHz	> 30 W @ 1% THD+N
	Input Sensitivity	~650 mV - full power
	Maximum input voltage (RMS)	1 V
	Signal to noise ratio (SNR) at THD+N < 1%, f = 1 kHz, Gain = 26 dB	90 dB
	Total Harmonic Distortion THD + N@1 KHz	< 0.1%
Wireless network compatibility	IEEE802.11 b/g/n 2.4GHz	
Supported audio formats	APE、FLAC、MP3、WAV、AAC、AAC+、WMA、ALAC、AIFF	
Streaming Protocol	DLNA,Airplay,Spotify connect,Qplay	
Audio Decoding	Up to 24bit/192KHz	
Resolution	44.1kHz/24bit	
Ethernet	10/100M	
Smart home control	RS232,TCP/IP,Infrared IR	
Bluetooth	Bluetooth 5.0 Bluetooth Audio codec:SBC	
Supply voltage	DC:24V/3.3A AC:100-240V ~50/60Hz 2.5A	
Host weight	0.5kg	
Amplifier size (H x D x W)	223x189x32mm (With antenna)	
Power supply size (H x D x W)	129x57x32mm	
Product Code	SKU:AMPi50Bv2 EAN:6970504260160	

# IEAST Controller App



The IEAST controller app allows you to connect your product to the network via a smart-phone or tablet, and use multiple devices of our brand at the same time. The application is compatible with iOS and Android systems. Apple devices can be downloaded for free through the App Store, and Android devices can be downloaded by scanning the QR code.



## The IEAST controller app will allow you to:

- Configure AudioCast Pro to connect to the router (BLE or direct connection)
- Settings management: EQ/prompt sound/indicator
- Select input source (Wi-Fi/AUX In/Optical in)
- Manage multi-room mode
- What music is currently playing
- Volume adjustment
- Set favorite shows as presets
- Add and control other IEAST products at the same time
- Connect to more than 10,000 digital radios
- Play music stored on the phone
- Play music from streaming media (Deezer/Tidal//NAS...)

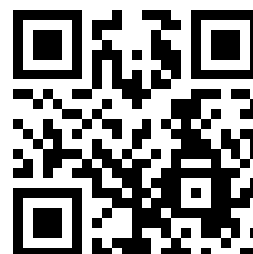

For Android, please scan the QR code to download and install

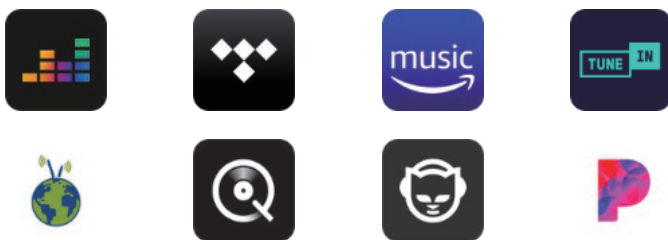

Apple iPhone/iPad/iPod/MAC can find AMP-i50Bv2 through "airplay"  
Spotify discovers AMP-i50Bv2 through "Spotify connect"

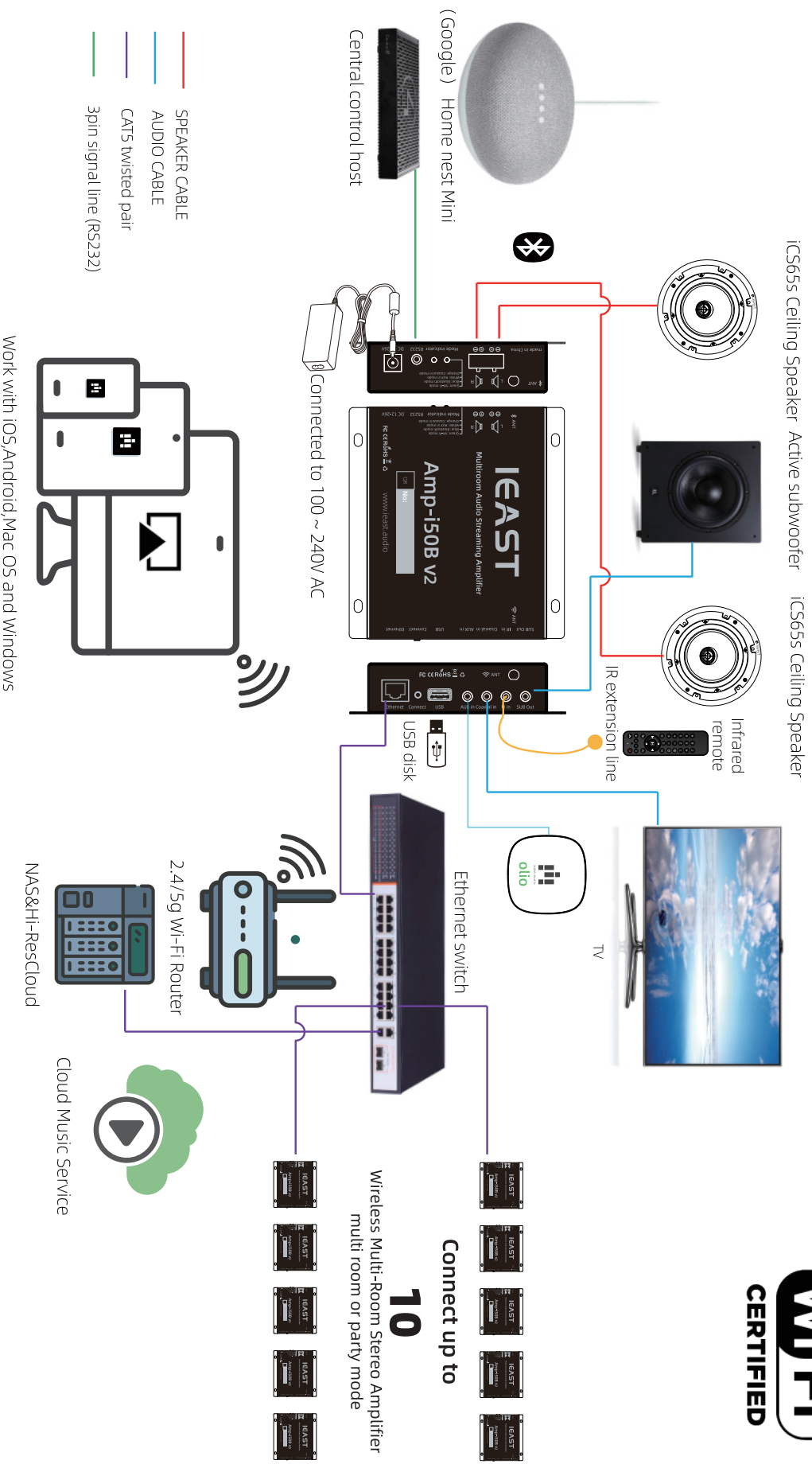

# How It Works